



item #
 model #
 project #
 sis #
 aia #

COOK & HOLD CHT281K

Static low
 temperature oven

CONSTRUCTION FEATURES

- Two Tightness chambers with radiuses corners
- Rubber bumpers
- Total thermic insulation with rock or glass wool
- Silicone rubber door gasket resistant to heat and aging
- Removable side tray racks for easy cleaning
- Static heating provided by low consumption wire heating element DeliWarm® that coils up all the chamber
- Ergonomic and fully built-in door handle with magnetic closure
- Mounted on four 125 mm diameter castors, two of which with brake
- Ergonomic back handle for pushing and guiding
- Easy access to facilitate maintenance and repair

FUNCTIONAL FEATURES

- Two Capacitive control panel with temperature, probe, time, holding, and program management settings
- Operating temperature 30°-120°C
- Adjustable humidity vents on the door
- Chamber with safety thermostat
- Manual keyboard lock
- End of cycle buzzer

STANDARD SUPPLY

- Removable GN 1/1 tray racks
- Internal core probe

OPTIONS & ACCESSORIES

- Set of adjustable feet
- Grids
- Trays
- Reversible door
- UK plug
- Smoker
- WiFi

MODULINESRL

moduline

TECHNICAL INSTALLATION DIAGRAM

Electricity supply
cable inlet



Vent for excess
humidity



Important - Drawing and
dimensions refer to the
standard version.
They may change with
the addition of
accessories
or options.

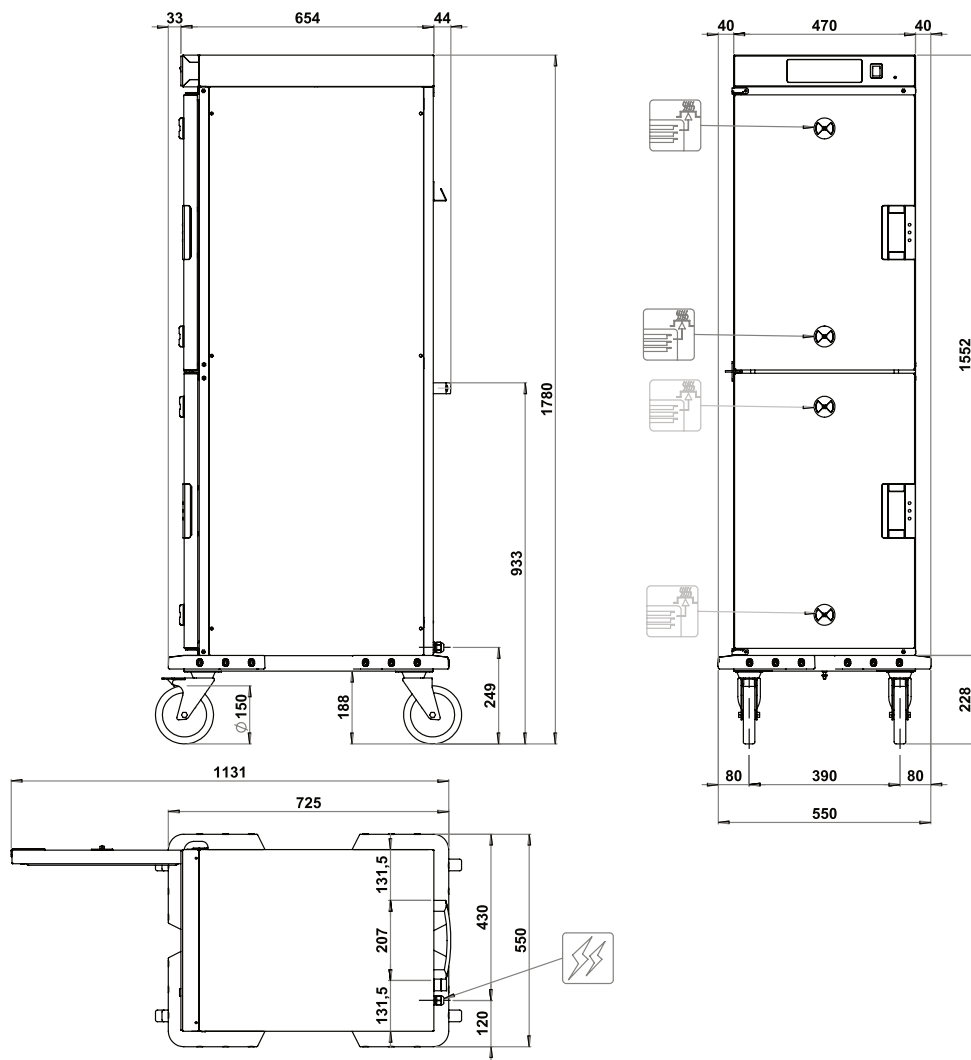

Overall dimensions
(W x D x H) - mm

550 x 725 x 1780 h

Trays capacity -
distance [mm]

(8+8) x GN 1/1 - (75)

Tray max. height
[mm]

8 x 65 (h) + 8 x 65 (h)
3 x 150 (h) + 3 x 150 (h)
2 x 200 (h) + 2 x 65 (h) e 2 x 200 (h) + 2 x 65 (h)

Power supply

AC 220-240V 50/60Hz

Total input
[kW]

2 (230V)

Amps.
[A]

8,7 (230V)

Working
temperature [°C]

30 ÷ 120

Product max
capacity [Kg]

40

Net weight
[Kg]

88



- A Chamber Temperature
- B Cooking time or by Probe
- C Holding Temperature or Holding by probe
- D Smoking (optional)
- E Programs (Save or Recall)
- F Increase value
- G Start / Stop
- H Decrease value
- I Info Display
- On/Off switch beside the board

MODULINESRL